

A

LINES 01 & 10
2 BEDROOMS / 2 BATHROOMS

TOTAL SQ.FT. 1,432 / TOTAL M² 133

AC Area 1,245 sq ft Terrace Area 187 sq ft

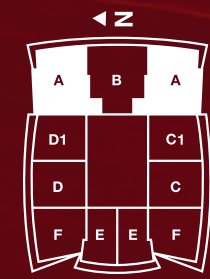

Overall dimensions are measured to the exterior boundaries of the exterior walls and the completion of interior finishing walls and in fact vary from the dimensions that would be determined by using the description and definition of the "Gross" and "Net" in the Declaration which generally only includes the interior spaces between the perimeter walls and excludes (interior structural components). For your reference, the area of the Unit, determined in accordance with those defined and boundaries, is = 1,174 sq ft. Note that measurements of rooms set forth on this floor plan are generally of the greatest portion of each given room and that some areas are partially enclosed, unless noted for any enclosure. Accordingly, the area of the actual rooms will typically be smaller than the provided dimensions in measuring the stated length these walls. All dimensions are approximate and may vary with actual construction, and all floor plans and development plans are subject to change.

B

LINE 11
2 BEDROOMS / 2 BATHROOMS + DEN

TOTAL SQ.FT. 1,462 / TOTAL M² 136

AC Area 1,270 sq ft Terrace Area 192 sq ft

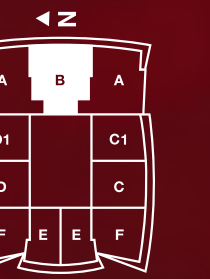

Overall dimensions are measured to the exterior boundaries of the exterior walls and the completion of interior finishing walls and in fact vary from the dimensions that would be determined by using the description and definition of the "Gross" and "Net" in the Declaration which generally only includes the interior spaces between the perimeter walls and excludes (interior structural components). For your reference, the area of the Unit, determined in accordance with those defined and boundaries, is = 1,228 sq ft. Note that measurements of rooms set forth on this floor plan are generally taken of the greatest portion of each given room and that some areas are partially enclosed, unless noted for any enclosure. Accordingly, the area of the actual rooms will typically be smaller than the provided dimensions in measuring the stated length these walls. All dimensions are approximate and may vary with actual construction, and all floor plans and development plans are subject to change.

D

LINE 08
1 BEDROOM / 1 BATHROOM

TOTAL SQ.FT. 975 / TOTAL M² 91
AC Area 858 sq ft Terrace Area 111 sq ft

D1

LINE 09
1 BEDROOM / 1 BATHROOM

TOTAL SQ.FT. 936 / TOTAL M² 87
AC Area 816 sq ft Terrace Area 120 sq ft

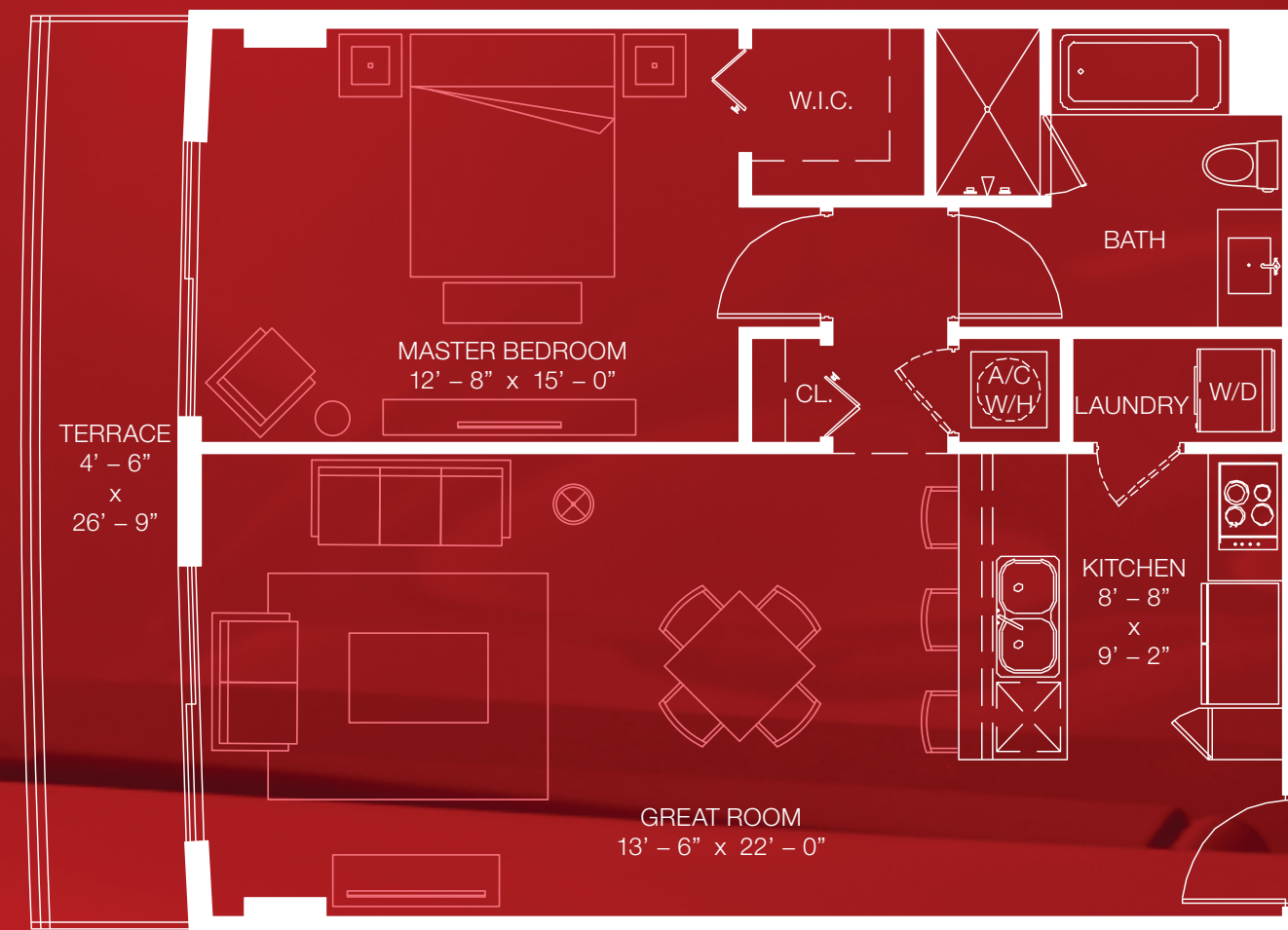

C

LINE 03
1 BEDROOM / 1 BATHROOM + DEN

TOTAL SQ.FT. 1,094 / TOTAL M² 102
AC Area 977 sq ft Terrace Area 117 sq ft

C1

LINE 02
1 BEDROOM / 1 BATHROOM + DEN

TOTAL SQ.FT. 1,062 / TOTAL M² 99
AC Area 942 sq ft Terrace Area 120 sq ft

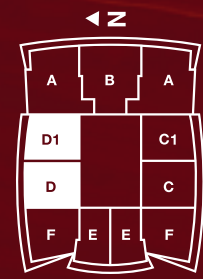
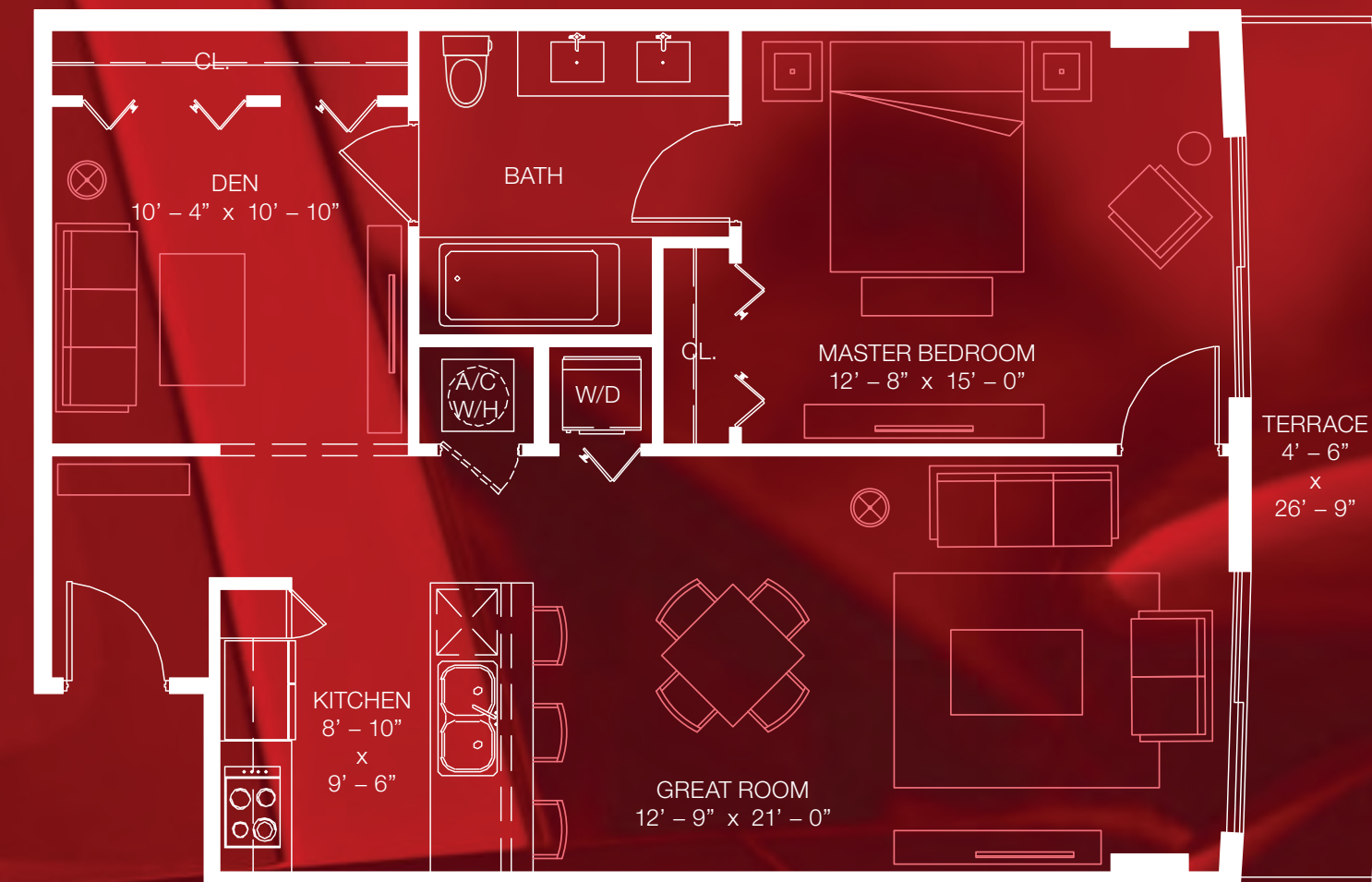

Standard dimensions are measured to the exterior face of the exterior walls and the centerline of interior demising walls and in fact vary from the dimensions that would be determined by using the description and definition of the "GSI" set forth in the Declaration which generally only includes the interior spaces between the perimeter walls and excludes interior structural components. For your reference, the area of the GSI, determined in accordance with those defined wall boundaries, is: +/- 815 sq ft, for unit D and +/- 777 sq ft, for unit D1. Note that measurements of rooms set forth on this floor plan are generally taken at the greatest points of each given room and do not take into account partitions, wall thicknesses for any corridor, alcove, etc. The area of the actual room will typically be smaller than the gross area obtained by multiplying the stated length times width. All dimensions are approximate and may vary with actual construction, and all floor plans and development plans are subject to change.

Standard dimensions are measured to the exterior face of the exterior walls and the centerline of interior demising walls and in fact vary from the dimensions that would be determined by using the description and definition of the "GSI" set forth in the Declaration which generally only includes the interior spaces between the perimeter walls and excludes interior structural components. For your reference, the area of the GSI, determined in accordance with those defined wall boundaries, is: +/- 941 sq ft, for unit C and +/- 903 sq ft, for unit C1. Note that measurements of rooms set forth on this floor plan are generally taken at the greatest points of each given room and do not take into account partitions, wall thicknesses for any corridor, alcove, etc. The area of the actual room will typically be smaller than the gross area obtained by multiplying the stated length times width. All dimensions are approximate and may vary with actual construction, and all floor plans and development plans are subject to change.

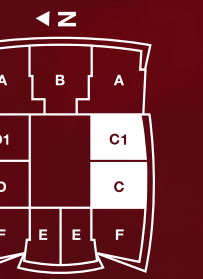

F

LINES 04 & 07 2 BEDROOMS / 1 BATHROOM

TOTAL SQ.FT. 1,202 / TOTAL M² 112

AC Area 996 sq ft Terrace Area 206 sq ft

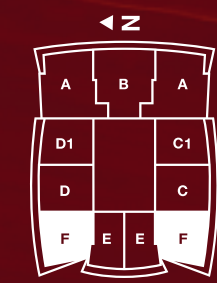
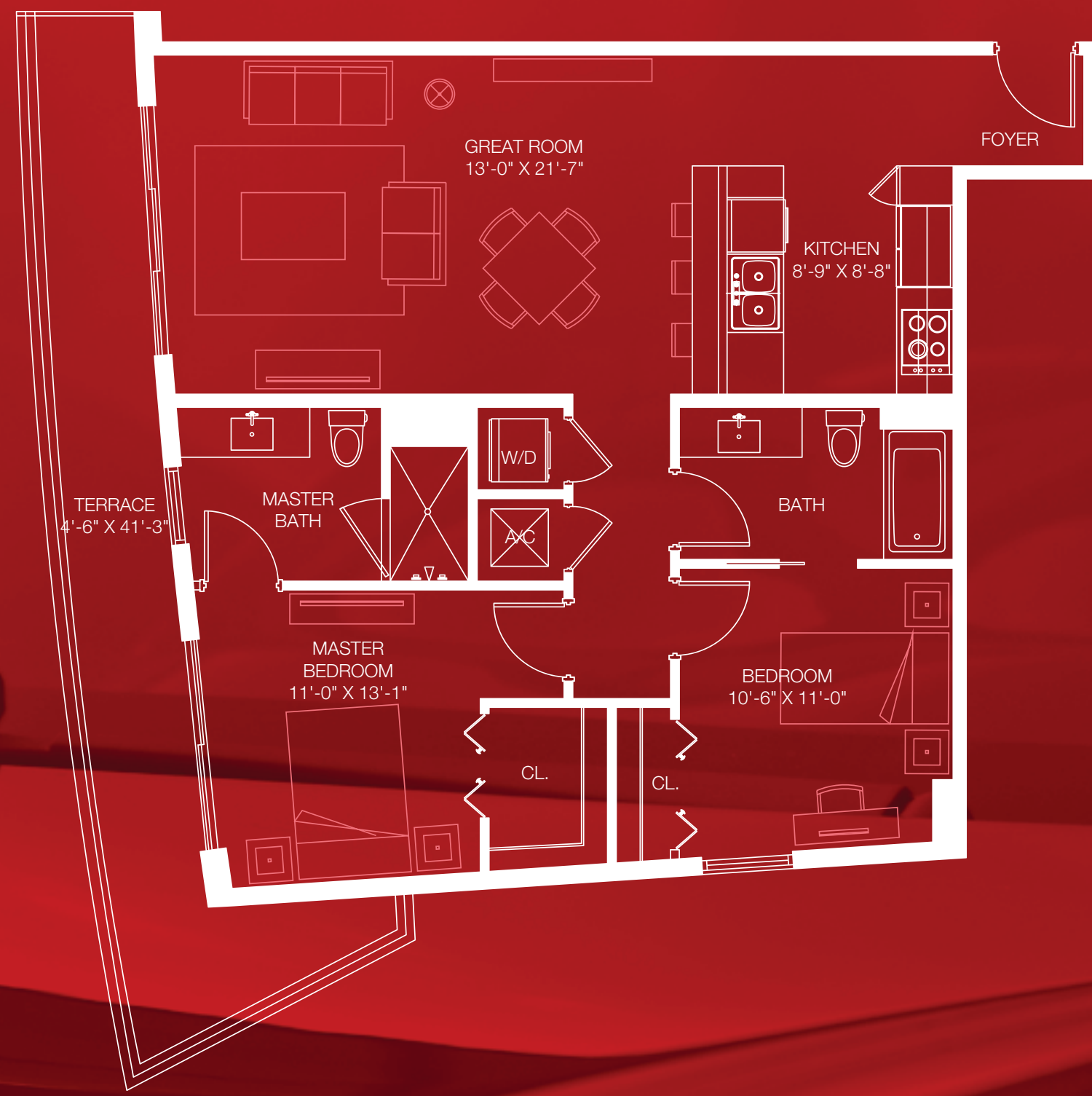

Overall dimensions are measured to the exterior boundaries of the exterior walls and the centerline of exterior balcony walls and is not true from the dimensions that would be determined by using the description and definition of the "GAP" set forth in the Declaration which generally only includes the interior spaces between the perimeter walls and excludes interior structural components. For your reference, the area of the Unit, determined in accordance with these defined unit boundaries, is +/- 1,206 sq ft. Note that measurements of rooms and both on this floor plan are generally taken at the greatest points of each given room and this does not represent a perfect rectangle, without regard for any columns. Accordingly, the area of the actual room will typically be smaller than the product obtained by multiplying the stated length times width. All dimensions are approximate and may vary with actual construction, and all floor plans and development plans are subject to change.

E

LINES 05 & 06 STUDIO / 1 BEDROOM CONVERTIBLE

TOTAL SQ.FT. 700 / TOTAL M² 65

AC Area 578 sq ft Terrace Area 122 sq ft

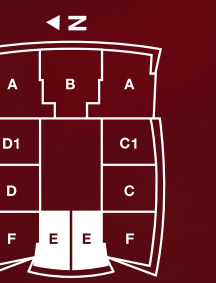
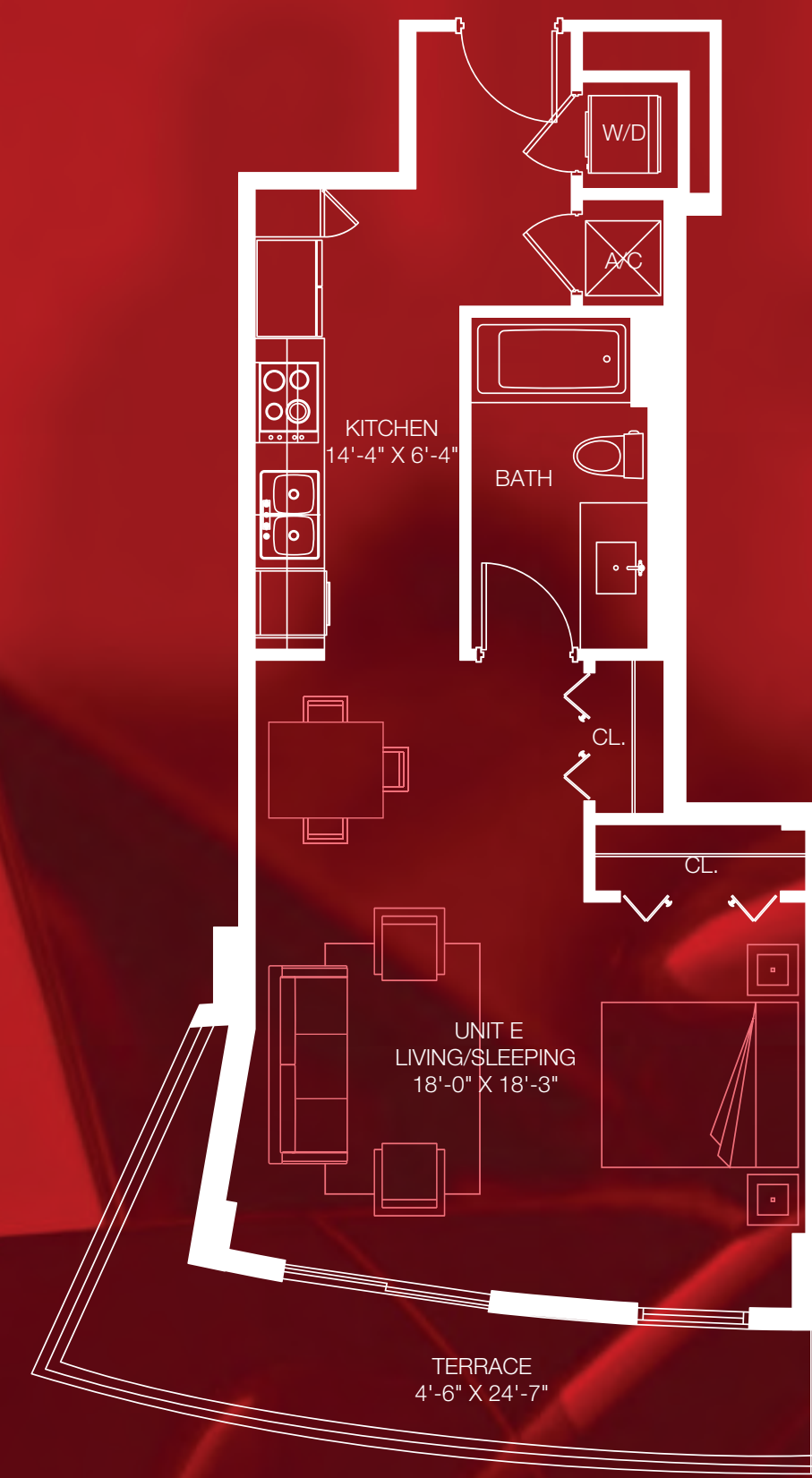

Overall dimensions are measured to the exterior boundaries of the exterior walls and the centerline of exterior balcony walls and is not true from the dimensions that would be determined by using the description and definition of the "GAP" set forth in the Declaration which generally only includes the interior spaces between the perimeter walls and excludes interior structural components. For your reference, the area of the Unit, determined in accordance with these defined unit boundaries, is +/- 702 sq ft. Note that measurements of rooms and both on this floor plan are generally taken at the greatest points of each given room and this does not represent a perfect rectangle, without regard for any columns. Accordingly, the area of the actual room will typically be smaller than the product obtained by multiplying the stated length times width. All dimensions are approximate and may vary with actual construction, and all floor plans and development plans are subject to change.